

Austin-Healey No. 1
Issue 3

The



CARBURETTORS

FITTED TO THE

AUSTIN-HEALEY HUNDRED

(TYPE H4. SPECIFICATION No. AUC718) 1953

(TYPE H6. SPECIFICATION No. AUC739) 1954

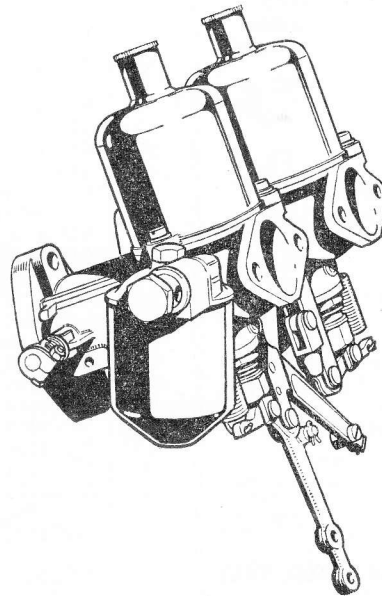

MANUFACTURED

by

THE S.U. CARBURETTOR COMPANY LIMITED

Proprietors: MORRIS MOTORS LIMITED

WOOD LANE • ERDINGTON • BIRMINGHAM 24

TELEPHONE: ERDINGTON 7371 (7 lines)

TELEGRAMS: CARBURFLEX, BIRMINGHAM

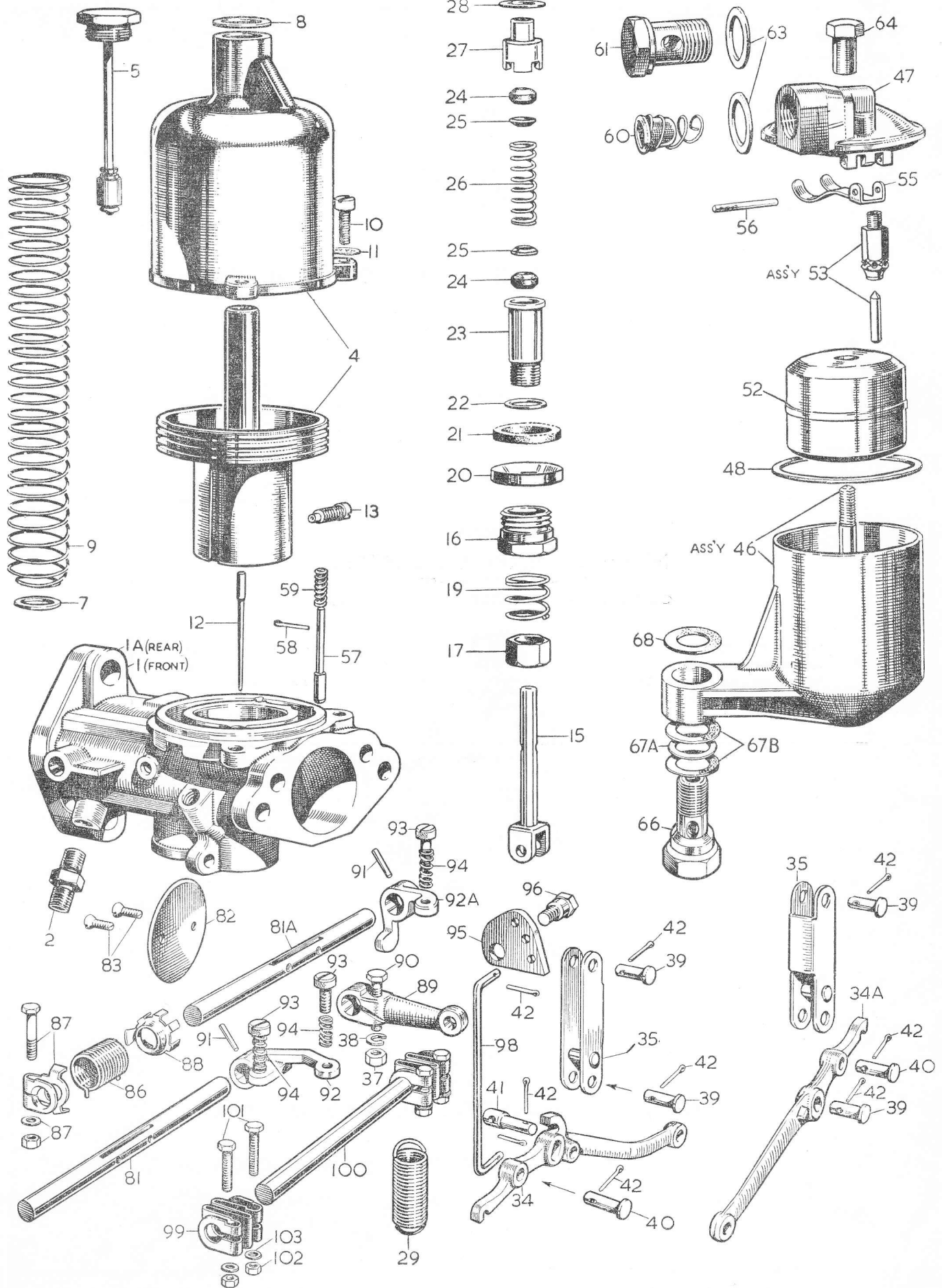

AUSTIN-HEALEY HUNDRED SPORTS

Specification Nos. AUC718 and AUC739

PAIR OF CARBURETTERS (DUSTPROOFED)

Item No.	Part No.	Qty. off	DESCRIPTION	Item No.	Part No.	Qty. off	DESCRIPTION
—	Spec. No.						
—	AUC718	1	Carburettor complete—front—H4.	46	AUC3496	2	FLOAT-CHAMBER SUB-ASSEMBLY
—	AUC718	1	Carburettor complete—rear—	47	AUC1161	1	Float-chamber—bare—with stud and plug.
—	AUC9004	1	Carburettor complete—front—H6.	47	AUC4261	2	Float-chamber lid—AUC718.
—	AUC9005	1	Carburettor complete—rear—	48	AUC1147	2	Float-chamber lid—AUC739.
				52	AUC1123	2	Oakenstrong washer—lid.
				53	AUC8170	2	Float.
				55	AUC1980	2	Float needle and seat assembly.
1	AUC6031	1	Body—bare—front } Spec.	56	AUC1152	2	Float—hinged lever.
1A	AUC6033	1	Body—bare—rear } AUC718.	60	AUC2139	2	Pin—hinged lever.
NI	AUC6053	1	Body—bare—front } Spec.	61	AUC2698	2	Filter.
NI	AUC6047	1	Body—bare—rear } AUC739.	63	AUC2141	2	Banjo bolt.
2	AUC4490	1	Ignition union—rear carburettor.	64	AUC5069	4	Fibre washer—banjo bolt.
57	AUC1249	2	Piston lifting pin.	NI	AUC1867	2	Cap nut—brass—short (Spec. AUC718).
58	AUC1250	2	Circlip.	NI	AUC1928	2	Cap nut—brass—long.
59	AUC1151	2	Spring—piston lift pin.	NI	AUC1557	2	Fibre washer—serrated—cap nut } Spec.
				NI	AUC3202	2	Aluminium washer—cap nut } AUC739.
				NI	AUC3202	2	Drain pipe and banjo assembly
				66	AUC1541	2	Holding-up bolt—floatchamber.
4	AUC8015	2	Suction chamber and piston assembly (Spec. AUC718).	67A	AUC5026	2	Brass skid washer } Supplied in sets.
NI	AUC8023	2	Suction chamber and piston assembly (Spec. AUC739).	67B	AUC5027	4	Fibre washer }
5	AUC8102	2	Oil cap damper assembly.	68	AUC2130	2	Fibre washer—holding-up bolt.
7	AUC3071	2	Thrust washer.				
8	AUC4900	2	Fibre washer—oil cap.				
9	AUC1167	2	Piston spring—yellow (Spec. AUC718).				
NI	AUC4387	2	Piston spring—red (Spec. AUC739).	81	AUC3212	1	THROTTLE SPINDLES, COUPLING, AND LEVERS SUB-ASSEMBLY
10	AUC2175	6	Screw—suction chamber securing.				
11	AUC4643	6	Shakeproof washer.	81A	AUC3436	1	Throttle spindle—front carburettor } Spec.
12	QW	2	Jet needle—standard (Spec. AUC718).				
NI	OA7	2	Jet needle—standard (Spec. AUC739).	NI	AUC4284	2	Throttle spindle—rear carburettor } AUC718.
13	AUC2468	2	Jet needle locking screw.	NI	AUC4284	2	Throttle spindle (Spec. AUC739).
				82	AUC3116	2	Throttle disc.
15	AUC8182	2	Jet with head .090" (Spec. AUC718).	83	AUC1358	4	Screw—throttle disc.
NI	AUC8183	2	Jet with head .100" (Spec. AUC739).	86	AUC4781	2	Return spring—throttle.
16	AUC3232	2	Jet screw.	87	AUC4771	2	Retaining clip (with bolt AUC2669, nut AUC2673, washer AUC4612).
17	AUC2121	2	Jet adjusting nut.	88	AUC4770	2	Anchor plate.
19	AUC2114	2	Lock spring—adjusting nut.	89	AUC1196	1	Throttle lever—front carburettor.
20	AUC2117	2	Jet sealing ring—brass.	90	AUC2694	1	Bolt—throttle lever—2 BA.
21	AUC2118	2	Jet sealing ring—cork.	37	AUC2156	1	Nut—throttle lever—2 BA.
22	AUC3233	2	Jet copper washer—bottom half.	38	AUC2246	1	Spring washer—2 BA.
23	AUC3231	2	Jet bearing—bottom half.	91	AUC2106	2	Taper pin.
24	AUC2120	4	Jet gland washer—cork.	92	AUC4713	1	Throttle stop—front carburettor.
25	AUC2119	4	Jet gland washer—brass.	92A	AUC2199	1	Throttle stop—rear carburettor.
26	AUC1158	2	Jet gland spring.	93	AUC3464	3	Screw—throttle stop adjusting.
27	AUC3230	2	Jet bearing—top half.	94	AUC3465	3	Spring—adjusting screw.
28	AUC2122	2	Jet copper washer—top half.	95	AUC4730	1	Cam—low lobe—front carburettor.
29	AUC4667	2	Return spring jet lever.	96	AUC3471	1	Pivot bolt—cam—front carburettor.
				NI	AUC3472	1	Spring washer—pivot bolt—front carburettor.
				98	AUC4732	1	Link rod—intermediate jet and throttle (Spec. AUC718)—front carburettor.
				98	AUC5055	1	Link rod—intermediate jet and throttle (Spec. AUC739)—front carburettor.
34	AUC4823	1	Jet lever—front carburettor.	99	AUC4334	2	Coupling—assembly
34A	AUC4816	1	Jet lever—rear carburettor.	100	AUC2397	1	Connecting rod (Spec. AUC.718).
35	AUC4819	2	Jet link.	NI	AUC2402	1	Connecting rod (Spec. AUC.739).
39	AUC2381	4	Pivot pin—short.	101	AUC2669	4	Bolt—4 BA—coupling.
40	*AUC2108	2	Pivot pin—long.	102	AUC2673	4	Nut—4 BA—coupling.
41	AUC4631	1	Link pin—front carburettor.	103	AUC4612	4	Washer—4 BA—coupling.
42	AUC2109	9	Split pin— $\frac{1}{16}$ ".				
NI	†AUC5011	1	Swivel pin—front				
NI	†AUC5002	1	Starlock washer				
NI	†AUC5009	2	Pivot pin—jet				
NI	†AUC5004	2	Starlock washer—pivot pin				

* Used with solid head jet. When pressed head jet is fitted use AUC.2381 pivot pin—short.

† Amended to suit circlip fixing.

NI=Not illustrated.

SOLE EXPORTERS

NUFFIELD EXPORTS LIMITED

Proprietors: Morris Motors Limited

COWLEY - OXFORD - ENGLAND

Telephone: OXFORD 77733

Telex: MOREX, OXFORD

Telegrams and Cables: MOREX, OXFORD



Codes: BENTLEY'S, BENTLEY'S SECOND
PHRASE, A.B.C. (5th and 6th EDITIONS),
WESTERN UNION AND PRIVATE